

Notice of Meeting

Licensing Sub-Committee

Monday 20th August 2012 at 10.00 am

in Council Chamber, Council Offices,
Market Street, Newbury

Members Interests

Note: If you consider you may have an interest in any Application included on this agenda then please seek early advice from the appropriate officers.

Date of despatch of Agenda: Friday, 10 August 2012

FURTHER INFORMATION FOR MEMBERS OF THE PUBLIC

If you require further information about this Agenda, or to inspect any background documents mentioned in the reports, please contact Denise Anns - Tel: (01635) 519486 - Email: danns@westberks.gov.uk.

Further information and Minutes are also available on the Council's website at www.westberks.gov.uk

McDonalds Restaurant Pinchington Lane Newbury RG14 7HU



Agenda - Licensing Sub-Committee to be held on Monday, 20 August 2012 (continued)

To: Councillors Peter Argyle, Paul Bryant (Chairman), Geoff Mayes and
Quentin Webb

Substitute: Councillor Manohar Gopal

Agenda

Part I

Page No.

- | | | |
|-----|-----------------------------------------------------------------------------------------------------------------------------------------------------------------------------------------------------------------------------------------------------------------------|---------|
| 1 | Declarations of Interest
To receive any declarations of interest from Members. | |
| 2 | Schedule of Licensing Applications | |
| (1) | Application No. 12/01110/LQN - McDonalds Restaurant Pinchington Lane
Proposal: Application to vary the Premise Licence
Location: McDonald's Restaurant, Pinchington Lane, Newbury RG14 7HU
Applicant: McDonald's Restaurants Ltd | |
| (2) | Existing Licence - McDonald's Restaurant Pinchington Lane | 1 - 4 |
| (3) | Application to vary a Premise Licence | 5 - 20 |
| (4) | Plan of McDonald's Restaurant | 21 - 22 |
| (5) | Town Council Representation | 23 - 24 |

Andy Day
Head of Strategic Support

West Berkshire Council is committed to equality of opportunity. We will treat everyone with respect, regardless of race, disability, gender, age, religion or sexual orientation.

If you require this information in a different format, such as audio tape, or in another language, please ask an English speaker to contact Moira Fraser on telephone (01635) 519045, who will be able to help.



West Berkshire
C O U N C I L

West Berkshire District Council

Culture And Environmental Protection, Environmental Health & Licensing, Council Offices,
Market Street, Newbury, Berkshire RG14 5LD
Tel: (01635) 519184 Fax (01635) 519172

Licensing Act 2003 Premises Licence

Uniform Ref: 11/00074/LQN

Premises licence number 09/01622/LQN

Part 1 - Premises details

Postal address of premises, or if none, ordnance survey map reference or description

McDonalds Ltd,
Newbury Retail Park, Pinchington Lane, Newbury, Berkshire, RG14 7HU

Licensable activities authorised by the licence

Late Night Refreshment

The times the licence authorises the carrying out of licensable activities

Late Night Refreshment

Monday to Sunday From 23:00 to 05:00

Activity will take place Indoors/Outdoors : **Both**

Further Details: The premises will operate as a restaurant selling food and non-alcoholic drinks for consumption on and off the premises.

The opening hours of the premises

Monday to Sunday From 05:00 to 05:00

Part 2

Name, (registered) address, telephone number and email (where relevant) of holder of premises licence

McDonalds Restaurants Limited
11/59 High Road, East Finchley, London, N2 8AW

0208 700 7000

Registered number of holder, for example company number, charity number (where applicable)

01002769

Date: 11th June 2012

Signed:



Authorised Officer

Licence granted 15/07/2009
Variation granted 09/03/2011
Correction 11/06/2012

**Annex 1 - Mandatory conditions
(None)**

Annex 2 - Conditions consistent with the operating Schedule dated 11/01/2011

Annex 3 - Conditions attached after a hearing by the licensing authority

Hearing dated 14/07/2009

1. Late Night refreshment shall not be available for consumption on the premises.
2. No Late night refreshment will be provided to patrons visiting the premises on foot during the hours when late night refreshment is provided from the premises.
3. A minimum of 2 CCTV cameras shall be in operation during the hours when late night refreshment is provided from the premises. These cameras will record digital images in colour covering the external area of the licensed premises.
4. The licensee shall provide a contact number by which members of the public can contact staff working at the premises during the hours when late night refreshment is provided from the premises. This number shall be displayed at all times in prominent places on the external fabric of the premises.
5. The licensee shall undertake regular litter patrols to collect litter, which has been discarded at the premises and immediate surrounding area, which shall include the car park attached to the premises.
6. A record shall be maintained of the litter collections, which shall record the fact that the litter collection was undertaken and the member(s) of staff who undertook the litter collection. The record of litter collections shall be retained for a minimum period of 12 months and shall be made available for inspection by licensing officers on request.

Annex 4 - Plans as submitted 19/05/2009

West Berkshire District Council

Culture And Environmental Protection, Environmental Health & Licensing, Council Offices, Market Street,
Newbury, Berkshire RG14 5LD
Tel: (01635) 519184 Fax (01635) 519172

Licensing Act 2003 Premises Licence Summary

Uniform Ref: 11/00074/LQN

Premises licence number

09/01622/LQN

Premises details

Postal address of premises, or if none, ordnance survey map reference or description

McDonalds Ltd,
Newbury Retail Park, Pinchington Lane, Newbury, Berkshire, RG14 7HU

Licensable activities authorised by the licence

Late Night Refreshment

The times the licence authorises the carrying out of licensable activities

Late Night Refreshment

Monday to Sunday From 23:00 to 05:00

Activity will take place Indoors/Outdoors : **Both**

Further Details: The premises will operate as a restaurant selling food and non-alcoholic drinks for consumption on and off the premises.

The opening hours of the premises

Monday to Sunday From 05:00 to 05:00

Name, (registered) address of holder of premises licence

McDonalds Restaurants Limited
11/59 High Road, East Finchley, London, N2 8AW

Date: 11th June 2012

Signed:

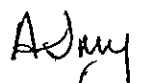

Authorised Officer

Licence granted 15/07/2009
Variation granted 09/03/2011
Correction 11/06/2012

(check Annual renewal fee
tell Sharon

Agenda Item 2(3)

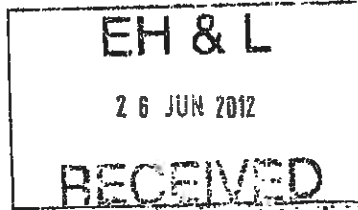
shoosmiths



West Berkshire Council
Senior Licensing Officer
Public Protection Department
Council Offices
Market Street
Newbury
RG14 5LD

The Lakes
Northampton
NN4 7SH
DX 712280 Northampton

T 03700 863000
F 03700 863001

Elaine.Rayner@shoosmiths.co.uk
T Direct Dial : 03700 863086

Delivered: by post

Your Ref

EXR 130024.796

Our Ref

(PLEASE QUOTE ON ALL CORRESPONDENCE)

Date

25th June 2012

Dear Sirs

**MCDONALD'S RESTAURANTS LIMITED
NEWBURY RETAIL PARK PINCHINGTON LANE NEWBURY BERKSHIRE RG13 1AE
APPLICATION TO VARY A PREMISES LICENCE**

We act on behalf of McDonald's Restaurants Limited. Please find enclosed:-

1. Application to vary a Premises Licence;
2. Original Premises Licence and Premises Licence Summary;
3. Amended plans;
4. Cheque in the sum of £315.00.

We should be grateful if you would acknowledge safe receipt.

Yours faithfully

A handwritten signature in cursive script, appearing to read "Sharon".

**McDonald's Licensing Team at
Shoosmiths**

LIC4

R/N 142689 £315-00 26-6-12

Insert name and address of relevant licensing authority and its reference number (optional)

West Berkshire Council
Public Protection Department
Council Offices
Market Street
Newbury
RG14 5LD

EH & L
26 JUN 2012
RECEIVED

Application to vary a premises licence under the Licensing Act 2003

PLEASE READ THE FOLLOWING INSTRUCTIONS FIRST

Before completing this form please read the guidance notes at the end of the form. If you are completing this form by hand please write legibly in block capitals. In all cases ensure that your answers are inside the boxes and written in black ink. Use additional sheets if necessary. You may wish to keep a copy of the completed form for your records.

XWe McDonald's Restaurants Limited
(Insert name(s) of applicant)

being the premises licence holder, apply to vary a premises licence under section 34 of the Licensing Act 2003 for the premises described in Part 1 below

Premises licence number

09/01622/LQN

Part 1 - Premises Details

Postal address of premises or, if none, ordnance survey map reference, or description

McDonald's Restaurants Limited
Newbury Retail Park
Pinchington Lane

Post town Newbury

Post code RG13 1AE

Telephone number at premises (if any)

01635 529253

Non-domestic rateable value of premises

£ 83,000.00

Part 2 - Applicant Details

Daytime contact telephone number

E-mail address (optional)

Current postal address if different from premises address

11/59 High Road
East Finchley

Post Town

London

Postcode

N2 8AW

Part 3 - Variation

Please tick Yes

Do you want the proposed variation to have effect as soon as possible?

 /

If not do you want the variation to take effect from

Day		Month		Year	

If your proposed variation would mean that 5,000 or more people are expected to attend the premises at any one time, please state the number expected to attend

Please describe briefly the nature of the proposed variation (Please see guidance note 1)

The Variation of the Premises Licence is to amend the plans currently attached, to show a new layout following a refurbishment at the premises.

In addition, following consultation with SNT Sgt David Milson of Thames Valley Police, the application is to remove the condition numbered 1 stating "Late Night Refreshment shall not be available for consumption on the premises".

Part 4 - Operating Schedule

Please complete those parts of the Operating Schedule below which would be subject to change if this application to vary is successful.

Provision of regulated entertainment

Please tick Yes

- a) plays (if ticking yes, fill in box A)
- b) films (if ticking yes, fill in box B)
- c) indoor sporting events (if ticking yes, fill in box C)
- d) boxing or wrestling entertainment (if ticking yes, fill in box D)
- e) live music (if ticking yes, fill in box E)
- f) recorded music (if ticking yes, fill in box F)
- g) performances of dance (if ticking yes, fill in box G)
- h) anything of a similar description to that falling within (e), (f) or (g) (if ticking yes, fill in box H)

Provision of entertainment facilities for:

- i) making music (if ticking yes, fill in box I)
- j) dancing (if ticking yes, fill in box J)
- k) entertainment of a similar description to that falling within (i) or (j) (if ticking yes, fill in box K)

Provision of late night refreshment (if ticking yes, fill in box L)

 /

Sale by retail of alcohol (if ticking yes, fill in box M)

In all cases complete boxes N, O and P

A

Plays Standard days and timings (please read guidance note 6)			Will the performance of a play take place indoors or outdoors or both - please tick ✓ (please read guidance note 2)	Indoors	
Day	Start	Finish		Outdoors	
Mon			Please give further details here (please read guidance note 3)	Both	
Tue					
Wed			State any seasonal variations for performing plays (please read guidance note 4)		
Thur					
Fri			Non standard timings. Where you intend to use the premises for the performance of plays at different times to those listed in the column on the left, please list (please read guidance note 5)		
Sat					
Sun					

B

Films Standard days and timings (please read guidance note 6)			Will the exhibition of films take place indoors or outdoors or both - please tick ✓ (please read guidance note 2)	Indoors	
Day	Start	Finish		Outdoors	
Mon			Please give further details here (please read guidance note 3)	Both	
Tue					
Wed			State any seasonal variations for the exhibition of films (please read guidance note 4)		
Thur					
Fri			Non standard timings. Where you intend to use the premises for the exhibition of films at different times to those listed in the column on the left, please list (please read guidance note 5)		
Sat					
Sun					

C

Indoor sporting events Standard days and timings (please read guidance note 6)			<u>Please give further details</u> (please read guidance note 3)
Day	Start	Finish	
Mon			<u>State any seasonal variations for indoor sporting events</u> (please read guidance note 4)
Tue			
Wed			
Thur			<u>Non standard timings. Where you intend to use the premises for indoor sporting events at different times to those listed in the column on the left, please list</u> (please read guidance note 5)
Fri			
Sat			
Sun			

D

Boxing or wrestling entertainment Standard days and timings (please read guidance note 6)			Will the boxing or wrestling entertainment take place indoors or outdoors or both - please tick ✓ (please read guidance note 2)	Indoors	
Day	Start	Finish		Outdoors	
Mon			<u>Please give further details here</u> (please read guidance note 3)	Both	
Tue					
Wed			<u>State any seasonal variations for boxing or wrestling entertainment</u> (please read guidance note 4)		
Thur					
Fri					
Sat			<u>Non standard timings. Where you intend to use the premises for boxing or wrestling entertainment at different times to those listed in the column on the left, please list</u> (please read guidance note 5)		
Sun					

E

Live music Standard days and timings (please read guidance note 6)			Will the performance of live music take place indoors or outdoors or both - please tick ✓ (please read guidance note 2)	Indoors		
Day	Start	Finish		Outdoors		
Mon			Please give further details here (please read guidance note 3)	Both		
Tue						
Wed				State any seasonal variations for the performance of live music (please read guidance note 4)		
Thur						
Fri				Non standard timings. Where you intend to use the premises for the performance of live music at different times to those listed in the column on the left, please list (please read guidance note 5)		
Sat						
Sun						

F

Recorded music Standard days and timings (please read guidance note 6)			Will the playing of recorded music take place indoors or outdoors or both - please tick ✓ (please read guidance note 2)	Indoors		
Day	Start	Finish		Outdoors		
Mon			Please give further details here (please read guidance note 3)	Both		
Tue						
Wed				State any seasonal variations for playing recorded music (please read guidance note 4)		
Thur						
Fri				Non standard timings. Where you intend to use the premises for the playing of recorded music entertainment at different times to those listed in the column on the left, please list (please read guidance note 5)		
Sat						
Sun						

G

Performances of dance Standard days and timings (please read guidance note 6)			Will the performance of dance take place indoors or outdoors or both - please tick ✓ (please read guidance note 2)	Indoors		
Day	Start	Finish		Outdoors		
Mon			Please give further details here (please read guidance note 3)	Both		
Tue.						
Wed				State any seasonal variations for the performance of dance (please read guidance note 4)		
Thur						
Fri				Non standard timings. Where you intend to use the premises for the performance of dance entertainment at different times to those listed in the column on the left, please list (please read guidance note 5)		
Sat						
Sun						

H

Anything of a similar description to that falling within (e), (f) or (g) Standard days and timings (please read guidance note 6)			Please give a description of the type of entertainment you will be providing			
Day	Start	Finish	Will this entertainment take place indoors or outdoors or both - please tick ✓ (please read guidance note 2)	Indoors		
Mon				Please give further details here (please read guidance note 3)	Outdoors	
Tue			Both			
Wed			State any seasonal variations for entertainment of a similar description to that falling within (e), (f) or (g) (please read guidance note 4)			
Thur						
Fri			Non standard timings. Where you intend to use the premises for the entertainment of similar description to that falling within (e), (f) or (g) at different times to those listed in the column on the left, please list (please read guidance note 5)			
Sat						
Sun						

Provision of facilities for making music Standard days and timings (please read guidance note 6)			Please give a description of the facilities for making music you will be providing		
			Will the facilities for making music be indoors or outdoors or both - please tick ✓ (please read guidance note 2)	Indoors	
				Outdoors	
				Both	
Day	Start	Finish			
Mon			Please give further details here (please read guidance note 3)		
Tue					
Wed			State any seasonal variations for the provision of facilities for making music (please read guidance note 4)		
Thur					
Fri			Non standard timings. Where you intend to use the premises for provision of facilities for making music entertainment at different times to those listed in the column on the left, please list (please read guidance note 5)		
Sat					
Sun					

J

Provision of facilities for dancing Standard days and timings (please read guidance note 6)			Will the facilities for dancing be indoors or outdoors or both - please tick ✓ (see guidance note 2)	
			Indoors	
			Outdoors	
			Both	
Day	Start	Finish	Please give a description of the facilities for dancing you will be providing	
Mon			Please give further details here (please read guidance note 3)	
Tue				
Wed			State any seasonal variations for providing dancing facilities (please read guidance note 4)	
Thur				
Fri			Non standard timings. Where you intend to use the premises for the provision of facilities for dancing entertainment at different times to those listed in the column on the left, please list (please read guidance note 5)	
Sat				
Sun				

K

Provision of facilities for entertainment of a similar description to that falling within I or J Standard days and timings (please read guidance note 6)			Please give a description of the type of entertainment facility you will be providing		
Day	Start	Finish	Will the entertainment facility be indoors or outdoors or both - please tick ✓ (please read guidance note 2)	Indoors	
Mon				Outdoors	
				Both	
Tue			Please give further details here (please read guidance note 3)		
Wed			State any seasonal variations for the provision of facilities for entertainment of a similar description to that falling within I or J (please read guidance note 4)		
Thur					
Fri					
Sat			Non standard timings. Where you intend to use the premises for the provision of facilities for entertainment of a similar description to that falling within I or J at different times to those listed in the column on the left, please list (please read guidance note 5)		
Sun					

L

Late night refreshment Standard days and timings (please read guidance note 6)			Will the provision of late night refreshment take place indoors or outdoors or both - please tick ✓ (please read guidance note 2)		Indoors	
Day	Start	Finish			Outdoors	
Mon	23:00	05:00			Both	/
Tue	23:00	05:00			Please give further details here (please read guidance note 3) The premises will operate as a restaurant selling food and non-alcoholic drinks for consumption on and off the premises.	
Wed	23:00	05:00	State any seasonal variations for the provision of late night refreshment (please read guidance note 4)			
Thur	23:00	05:00	Non standard timings. Where you intend to use the premises for the provision of late night refreshment at different times, to those listed in the column on the left, please list (please read guidance note 5)			
Fri	23:00	05:00				
Sat	23:00	05:00				
Sun	23:00	05:00				

M

Supply of alcohol Standard days and timings (please read guidance note 6)			Will the sale of alcohol be for consumption please tick ✓ (please read guidance note 7)	On the premises				
				Off the premises				
				Both				
Day	Start	Finish	State any seasonal variations for the supply of alcohol (please read guidance note 4)					
Mon								
Tue								
Wed								
Thur								
Fri								
Sat								
Sun								
						Non standard timings. Where you intend to use the premises for the supply of alcohol at different times to those listed in the column on the left, please list (please read guidance note 5)		

N

Please highlight any adult entertainment or services, activities, other entertainment or matters ancillary to the use of the premises that may give rise to concern in respect of children (please read guidance note 8)

The premises will operate as an outlet of food and non-alcoholic drink and does not provide any adult entertainment or service that gives rise to a concern in respect of children

0

Hours premises are open to the public Standard days and timings (please read guidance note 6)			State any seasonal variations (please read guidance note 4)
Day	Start	Finish	
Mon...	05:00	05:00	
Tue	05:00	05:00	
Wed	05:00	05:00	
Thur	05:00	05:00	
Fri	05:00	05:00	
Sat	05:00	05:00	
Sun	05:00	05:00	

Non standard timings. Where you intend to use the premises to be open to the public at different times from those listed in the column on the left, please list (please read guidance note 5)

Please identify those conditions currently imposed on the licence which you believe could be removed as a consequence of the proposed variation you are seeking

Annex 3 - Conditions attached after a hearing by the licensing authority

1. Late Night refreshment shall not be available for consumption on the premises.

Please tick ✓ Yes

- I have enclosed the premises licence
- I have enclosed the relevant part of the premises licence

If you have not ticked one of these boxes please fill in reasons for not including the licence, or part of it, below

Reasons why I have failed to enclose the premises licence or relevant part of premises licence

P Describe any additional steps you intend to take to promote the four licensing objectives as a result of the proposed variation:

a) General - all four licensing objectives (b, c, d, e) (please read guidance note 9)

Please see attached Operating Schedule.

b) The prevention of crime and disorder

Please see attached Operating Schedule.

c) Public safety

Please see attached Operating Schedule.

d) The prevention of public nuisance

Please see attached Operating Schedule.

e) The protection of children from harm

Please see attached Operating Schedule.

Please tick ✓ Yes

- I have made or enclosed payment of the fee
- I have sent copies of this application and the plan to responsible authorities and others where applicable
- I understand that I must now advertise my application
- I have enclosed the premises licence or relevant part of it or explanation
- I understand that if I do not comply with the above requirements my application will be rejected

IT IS AN OFFENCE, LIABLE ON CONVICTION TO A FINE UP TO LEVEL 5 ON THE STANDARD SCALE, UNDER SECTION 158 OF THE LICENSING ACT 2003 TO MAKE A FALSE STATEMENT IN OR IN CONNECTION WITH THIS APPLICATION

Part 5 - Signatures (please read guidance note 10)

Signature of applicant (the current premises licence holder) or applicant's solicitor or other duly authorised agent (please read guidance note 11). If signing on behalf of the applicant please state in what capacity.

Signature Shoosmiths

Date 25th June 2012

Capacity Solicitor / Authorised Agent for the Applicant

Where the premises licence is jointly held signature of 2nd applicant (the current premises licence holder) or 2nd applicant's solicitor or other authorised agent (please read guidance note 12). If signing on behalf of the applicant please state in what capacity.

Signature

Date

Capacity

Contact name (where not previously given) and address for correspondence associated with this application (please read guidance note 13)

Shoosmiths
The Lakes

Post town Northampton

Post code NN4 7SH

Telephone number (if any) Direct Dial : 03700 863086

If you would prefer us to correspond with you by e-mail your e-mail address (optional)

elaine.rayner@shoosmiths.co.uk

Operating Schedule

General

This restaurant understands that in extending our opening hours we have a duty to the local community and that we continue to protect our staff and customers from danger and harm. We believe that the systems we have in place are robust, thorough and will, as far as reasonably practicable, secure the promotion of the four licensing objectives. It should be noted that no McDonald's restaurant within the United Kingdom serves alcohol and further none of our drinks or food are served to customers in glass receptacles.

We are eager to work in partnership with all responsible authorities to ensure the promotion of the four licensing objectives. We also seek to work with the local communities, whom we serve, in achieving a successful cohesion between our business operations and our neighbours.

Prevention of Crime and Disorder

This restaurant is keen to work in partnership with the local police force to prevent crime and disorder.

McDonald's operates a robust CCTV Policy to ensure compliance with Data Protection Legislation and to assist the Police with the prevention and detection of crime. At all stores where CCTV is in operation appropriate signage reflecting this information is displayed.

McDonald's operate digital motion activated CCTV systems where images are retained on a hard drive system. The CCTV equipment will be of a standard suitable to record images of a proper quality, it will meet the industry standard and will have Kalagate Certification. As part of the digital system an alarm will sound if the equipment is faulty or not recording, thereby alerting management for the need to intervene. The CCTV system is regularly serviced by qualified maintenance technicians.

Access to the CCTV system will be provided to Police Officers at their request.

At this restaurant all shift running managers have safety and security training.

Public Safety

This restaurant has safety systems in place to protect the safety of customers and staff at all times. These systems are regularly reviewed and updated where appropriate. In line with current legislation all our restaurants are routinely inspected by the local Environmental Health Office and we work with them and the local Fire Service to ensure we are complying, as far as reasonably practicable, with relevant Health and Safety and Fire Safety Legislation. This restaurant is subject to inspections from our own safety and security teams to ensure our systems are being maintained.

All of our restaurant staff are required to attend comprehensive safety training to ensure that safe working methods are adopted and all staff are trained in evacuation procedure in the event of a fire or other dangerous occurrence.

This store operates a "No Open Alcohol Containers" policy to prevent persons carrying open alcohol into the in-store area. Emergency contact mobile telephone numbers are listed in the Business Manager's office.

This restaurant is keen to work in partnership with the local Fire Service and Environmental Health Officer to ensure public safety.

Public Nuisance

McDonald's were the first company in our sector to introduce litter patrols in the early 1980's. These patrols collect McDonald's packaging and other litter within a certain radius of the restaurant. All of McDonald's packaging displays the "Bin It" symbol to encourage our customers to deal with their waste responsibly. We are happy to act on recommendations from the Environmental Health Officer should they feel that we should extend our patrol to a nearby area, as far as this is reasonably practicable. Our pioneering stance on litter patrols has meant working on a project with DEFRA, in

which we piloted 'reducing litter caused by food on the go', a voluntary code of practice for local partnerships. A copy of which can be found at:

www.defra.gov.uk/environment/localenv/litter/pdf/fastfoodcop.pdf

Further details regarding McDonald's commitment to reducing waste and litter nuisance can be found at the "Our World" section of the McDonald's website:

<http://www.mcdonalds.co.uk/ourworld/environment/policy.shtml>

We also have measures in place to limit noise. Our doors are self closing and we try to encourage our customers to be considerate to our neighbours and limit noise both when ordering their food and on leaving the local area.

The Protection of Children From Harm

McDonald's do not anticipate that children will use the restaurant in the extended hour's period covered by this licensing application. We do however take their safety extremely seriously and will continue to employ the same practices to ensure that they are protected from harm at all times when visiting the restaurant.

All of our restaurant staff are required to attend comprehensive safety training.

Notes for Guidance

This application cannot be used to vary the licence so as to extend the period for which the licence has effect or to vary substantially the premises to which it relates. If you wish to make that type of change to the premises licence you should make a new premises licence application under section 17 of the Licensing Act 2003.

Notes for Guidance

1. Describe the premises. For example the type of premises, its general situation and layout and any other information which could be relevant to the licensing objectives. Where your application includes off-supplies of alcohol and you intend to provide a place for consumption of these off-supplies you must include a description of where the place will be and its proximity to the premises.
2. Where taking place in a building or other structure please tick as appropriate. Indoors may include a tent.
3. For example state type of activity to be authorised, if not already stated, and give relevant further details, for example (but not exclusively) whether or not music will be amplified or unamplified.
4. For example (but not exclusively), where the activity will occur on additional days during the summer months.
5. For example (but not exclusively), where you wish the activity to go on longer on a particular day e.g. Christmas Eve.
6. Please give timings in 24 hour clock (e.g. 16:00) and only give details for the days of the week when you intend the premises to be used for the activity.
7. If you wish people to be able to consume alcohol on the premises please tick on, if you wish people to be able to purchase alcohol to consume away from the premises please tick off. If you wish people to be able to do both please tick both.
8. Please give information about anything intended to occur at the premises or ancillary to the use of the premises which may give rise to concern in respect of children regardless of whether you intend children to have access to the premises, for example (but not exclusively) nudity or semi-nudity, films for restricted age groups, the presence of gaming machines.
9. Please list here steps you will take to promote all four licensing objectives together.
10. The application form must be signed.
11. An applicant's agent (for example solicitor) may sign the form on their behalf provided that they have actual authority to do so.
12. Where there is more than one applicant, both applicants or their respective agents must sign the application form.
13. This is the address which we shall use to correspond with you about this application.



- NOTES**
- FIRE SAFETY EQUIPMENT**
- ☐ CO2 Extinguisher
 - ▽ Extinguishers
 - ◻ Portable Extinguisher
 - Fire Blanket
 - Fire alarm call point
 - ◻ Fire Exit

Note:
All fire stations have automatic fire suppression devices fitted.

Licenceable activity:
Sale of Hot food & Drink after 11pm.

Address:
0768 NEWBURY PARK
NEWBURY RETAIL PARK
PINCHINGTON LANE,
NEWBURY,
BERKSHIRE,
RG14 7HU
01635 529254

TITLE: Ground floor plan (For Licencing)

Date: May 2012	Drawn: C.T.S.G.	Arch:
Scale: 1:100@A3	Proj. No.: L0768/001	Rev. No.: 004

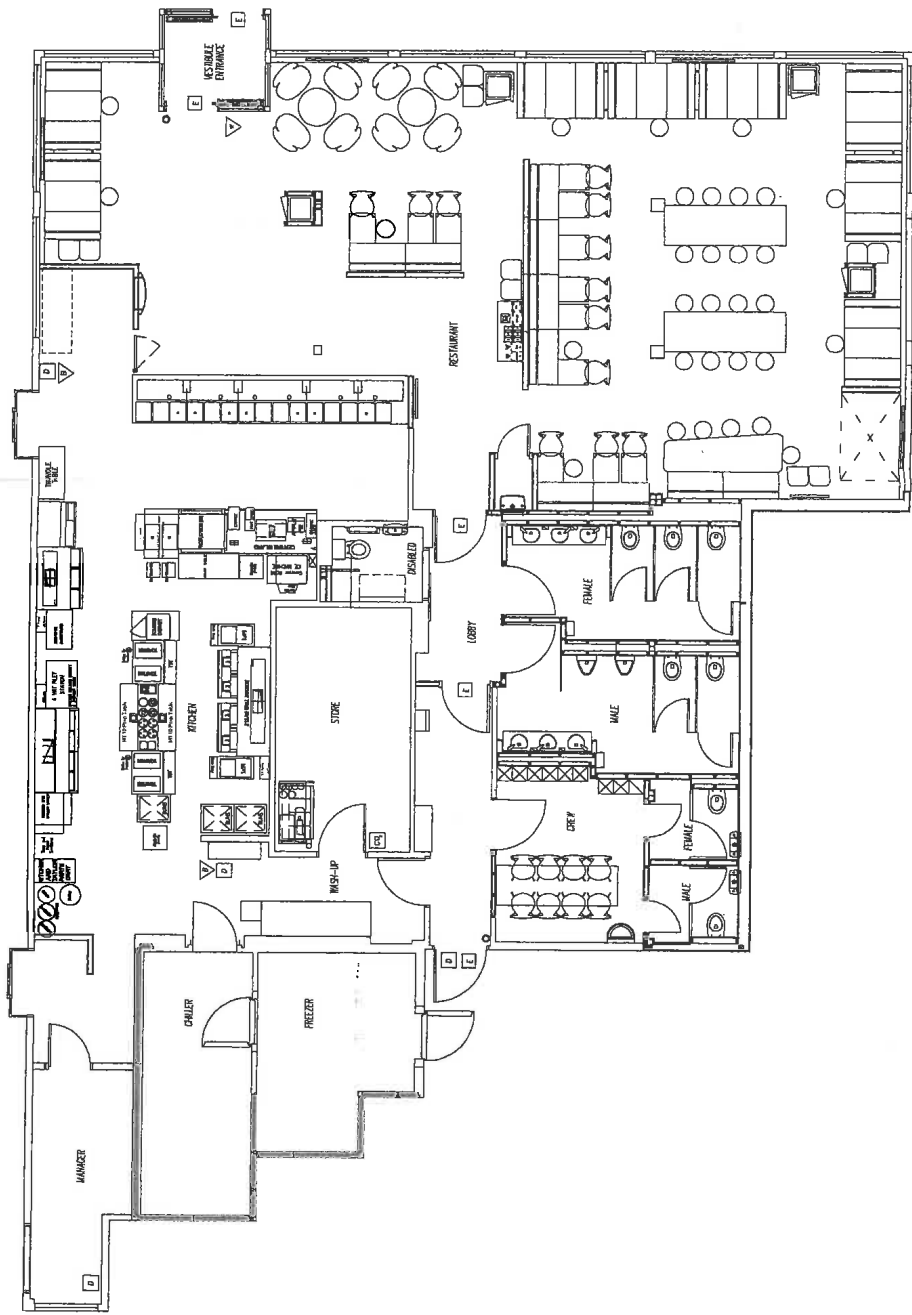

This page is intentionally left blank

Licensing

From: Graham Hunt [chiefexec@newbury.gov.uk]
To: Licensing
Cc: Margaret Gore
Subject: RE: NOTICE Licensing Act 2003
Attachments:

Sent: Tue 24/07/2012 2:49 PM

Amanda

The specific issues raised by Councillors at last night's Planning & Highways Committee meeting were:

- concern at removing a condition that was originally requested by the police
- concern that McDonalds have stated in the past that the police have not objected
- concern at the creeping extension to the licence over time
- concern that MacDonaldis have stated that there are no issues, but local residents' views are different
- concern that any further late night encouragement will lead to noise and disturbance to local residents at antisocial hours

Regards

Graham Hunt
Chief Executive Officer
Newbury Town Council

chiefexec@newbury.gov.uk / 01635 35486

www.newbury.gov.uk

This page is intentionally left blank